



SGR-PCB RELAYS 663

No. of contacts: **1 CO, 1 NO or 1 NC**
 Rated current: **16 A**
 Inrush current: **50 A**

Order description

SGR 663 ...VDC
 SGR 643 ...VDC
 SGR 623 ...VDC

Contact data

| | |
|--------------------------|--|
| Contact material | AgNi |
| Type of contact | Single contact |
| Rated switching capacity | 250 VAC 16A AC1 4000 VA |
| Max. switching voltage | 400 VAC |
| Electrical life | approx. 50.000 operations 250 VAC 16 A |
| Contact resistance | < 50 mΩ |

Coil data

| | |
|-------------------|--|
| Nominal voltages | 5-6-9-12-18-24--36-48-60-110 VDC |
| Pick-up voltage | approx. 0,7 x Nominal voltage (at 20 °C) |
| Power consumption | typically 400 mW |

Options

Contact material AgSnO₂ / ...+AU
 SGR 6x3 ...VDC ASO
 SGR 6x3 ...VDC +AU
 Sealed IP 67
 SGR 6x3V ...VDC ...

General data

| | |
|-------------------------------|---------------------------------|
| Mechanical life | 30 x 10 ⁶ Operations |
| Max. switching frequency | 350 Operations/h |
| Operate time | typically 8 ms |
| Release time | typically 4 ms |
| Bounce time | typically 2 ms |
| Vibration resistance | 10 g (10-55 Hz) |
| Test voltage coil-contact | 5.000 V _{eff} |
| Test voltage contact open | 1.000 V _{eff} |
| Weight | 11,5 g |
| Ambient temperature | -40°C - +85°C |
| Temperature of soldering bath | 270°C / 5 s |
| Protection category | IP 40 |

Accessories

PCB mounting socket
 ZGR 001
 Socket with screw terminals
 ZGE 007
 ZGE 107
 Modules
 ZAE ...

Tests, regulations

| | |
|-------------------------------|------------|
| Approvals | on request |
| Insulation group | C/250 |
| Creeping and leakage distance | 10 mm |

Diagrams

View from above

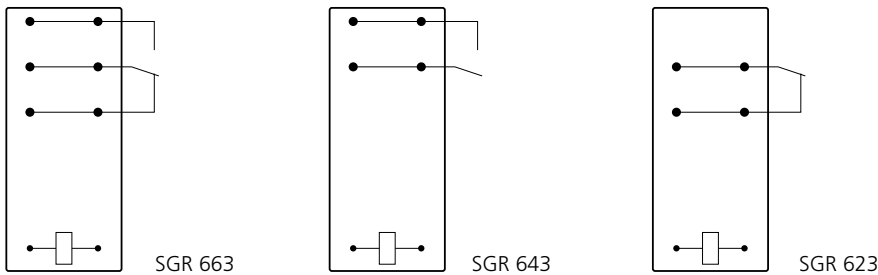

Dimensions drawing (mm)

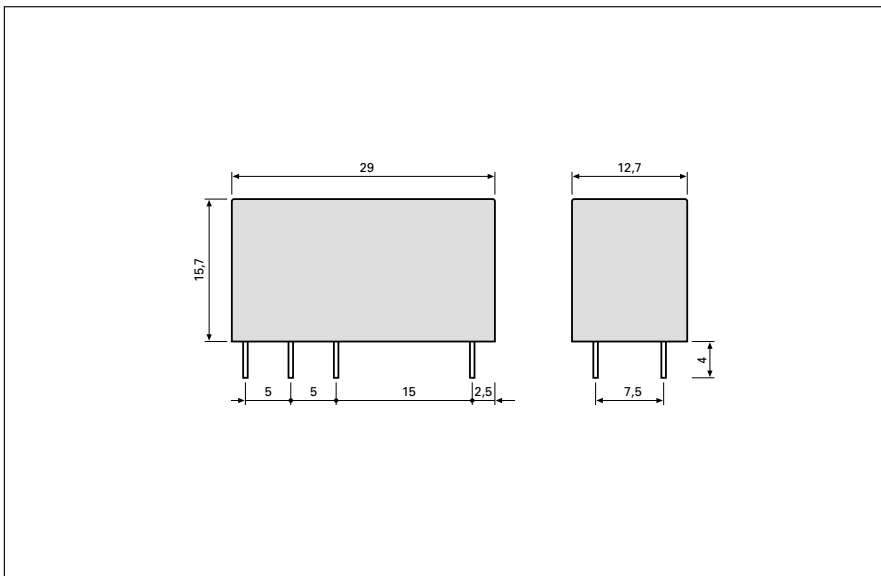

Drilling pattern (mm)

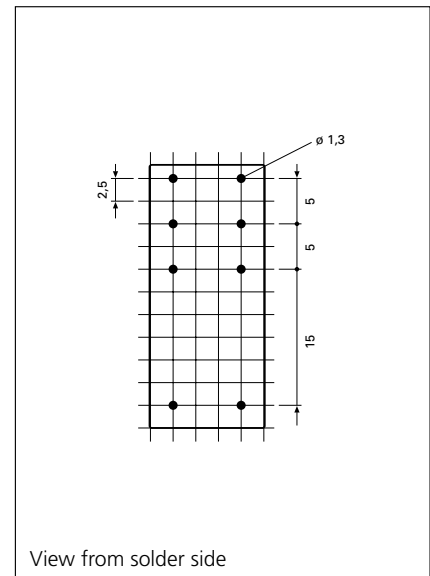

View from solder side

Coil data

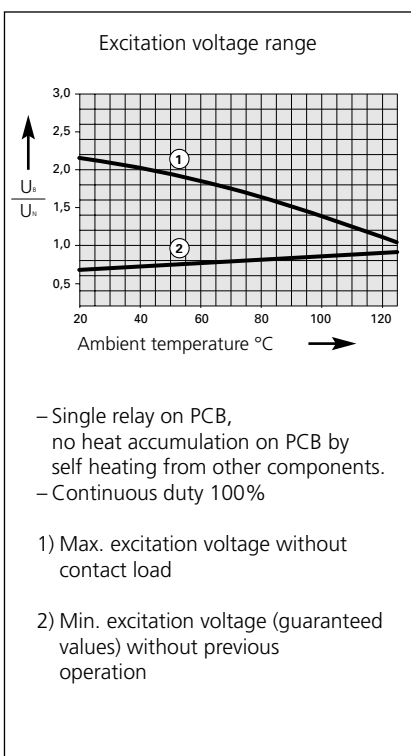

Standard coil for direct current (other voltages on request)

| Nominal spannung VDC | Min. pick-up voltage at 20°C | Drop-out spannung at 20°C | Nominal current mA | Resistance Ohm at 20°C | Tolerance % |
|----------------------------|------------------------------------|---------------------------------|--------------------------|------------------------------|----------------|
| 5 | 3,5 | 0,4 | 80,65 | 62 | 10 |
| 6 | 4,2 | 0,5 | 66,67 | 90 | 10 |
| 9 | 6,3 | 0,7 | 45,00 | 200 | 10 |
| 12 | 8,4 | 1,0 | 33,33 | 360 | 10 |
| 18 | 12,6 | 1,4 | 22,22 | 810 | 15 |
| 24 | 16,8 | 1,9 | 16,67 | 1.440 | 15 |
| 36 | 25,2 | 2,9 | 11,08 | 3.250 | 15 |
| 48 | 33,6 | 3,8 | 8,33 | 5.760 | 15 |
| 60 | 42,0 | 4,8 | 6,67 | 9.000 | 15 |
| 110 | 77,0 | 8,8 | 4,55 | 24.200 | 15 |